



## **Automotive Air-Conditioning Service Equipment**

### **WOW! COOLIUS 2700**

### **OPERATOR MANUAL**





## Content

1	Introduction .....	2
2	SAFETY FIRST! Important Safety Information's .....	3
3	Technical Features.....	4
4	Main components location .....	5
5	Preparing the Machine for the First Use.....	7
6	Printer .....	10
7	Refrigerant Cylinder Filling Procedure (Refrigerant Transfer).....	11
8	Connecting to the A/C system .....	12
9	Manual function selection procedure.....	13
9.1	Recovery & Recycling Mode.....	13
9.2	Evacuation Mode .....	15
9.3	Öl- und UV-Farbstoffeinfüllung .....	16
10	Automatic Cycle Procedure.....	18
11	Cylinder Air Purge .....	21
12	Contact .....	22



## 1 Introduction

WOW! Coolius 2700 - Fully Automatic Air-conditioning (A/C) Service Station is a user-friendly tool specifically designed for the automotive air-conditioning technicians, to carry out the following functions:

- Testing air-conditioning system,
- Recover and recycling the refrigerant from air-conditioning system,
- Electronically gauge amount of refrigerant recovered from air-conditioning system,
- Electronically gauge amount of oil removed from air-conditioning system (if any),
- Evacuate air-conditioning system,
- Electronically charge lubricating oil & UV dye by volume into the air-conditioning system,
- Electronically charge refrigerant into the air-conditioning system by weight.





The unit is a microprocessor control system. This provides electronically controlled functions, whilst keeping the operator constantly informed and in full control.

This unit has been designed and build to be long lasting and with high level of reliability including maximum safety for the operator. The operator needs only to be responsible for the proper use and maintenance of the unit, in accordance with the instructions found in this manual.

This manual contains important information pertinent to operator safety, and must accompany the unit, in the case of sale or transfer to another party.

Manufacturer reserves the right to modify this manual and the unit itself at any time without prior notice.

### Environmental information

-  This product may contain substances that can be hazardous to the environmental or to human health if it's not disposed of properly.
-  Electrical and electronic equipments should never be disposed of in the usual municipal waste, but must be separately collected for their proper treatment (recycling).
-  We also recommend that you adopt appropriate measures for environmental protection: recycling of the internal and external packaging of the product, including batteries (if any).
-  With your help it is possible to protect our planet and improve the quality of life, by preventing potentially hazardous substances being released in to our environment.



## 2 SAFETY FIRST! Important Safety Information's

WOW! Coolius 2700 unit is extremely simple and reliable in selecting and performing all its functions. Therefore, the user is not exposed to any risk, if the general safety guidelines reported below are followed, in association with proper use and maintenance of the unit (improper use and maintenance will reduce the safety of the unit).

- **Read this user manual carefully** before operating the unit. If you do not understand any section of this manual, please contact your nearest distributor or manufacturer.
- **This equipment is to be operated by accredited technician only!** Users must have basic knowledge of air-conditioning and refrigeration systems, including potential hazards associated with the handling of refrigerants and systems under high pressure.
- Handle refrigerant with care as serious injury may occur. Always wear appropriate protect clothing and safety glasses.



- **Avoid inhalation of the refrigerant or oil vapours.** Use only in well ventilated work areas.
- **Use only pure R134a** refrigerant with this equipment.
- Air-conditioners there impure with leak stop additives, are not be sucked off with this unite. Pleas use a Resycle-Guarde filter.
- Do not expose the machine to direct artificial heat or rain.
- Do not tamper with or change safety control devices or their settings.
- The power cable may only be connected to a socket with nominal voltage stated on the rating plate, located at the rear of the unit.
- Power lead plug to be connected only to **power point with an earth.**
- When transporting the unit **keep upright and remove refrigerant cylinder from platform.**
- Never operate the equipment with a damaged power lead, **replace it immediately.**
- **RISK OF ELECTRICAL SHOCK.** Before removing any protective cover from unit, **always unplug power lead from power point.**
- Do not cover ventilation openings on chassis cover when the unit is operating.
- Maintenance is to be carried out as per the manufacturer recommendation shown in this manual. **Only Ariazone genuine parts are to be used for maintenance and repairs.**
- **Expendable parts are not defeated by the guarantee, this encloses:**
  - All parts applied for the service.
  - Mechanically damaged hoses and pipes.
  - Fast clutches of the high and low pressure side.
- The small service is to be executed after 100 hours
- The small service is to be executed after 300 hours
- Maintenance of the unit must only be performed by an authorized technician. Only non aggressive substances to be used for cleaning of the unit.
- WOW! Coolius 2700 does not contents flammable gases.
- By disregard of the named points, there consists no guarantee claim



### 3 Technical Features

Refrigerant .....	R134a
Electronic refrigerant scale .....	+/- 10 g resolution
Load cell .....	60kg with 150% overload capacity
LP and HP gauges .....	D 68 mm kl.1.0
Recovery cylinder .....	27kg
Recovery pump .....	FR11G, 275W
Recovery rate .....	400 g/min (liquid state)
Vacuum pump .....	2 stage, 100 l/min (3.5cfm),
Vacuum .....	3 x 10 <sup>-1</sup> Pa
Filter dryers (main) .....	Al 162-1/4" (x 1)
Filters dryer (primary).....	Al 032-1/4" (x 2)
Dimensions .....	620 mm, 590mm, H-1090 mm
Weight .....	84 kg
Chassis .....	Sturdy all steel construction, powder coated
Supply voltage .....	230VAC- 50/60Hz
Power .....	700 W
Max. Currency .....	6.7A
Working conditions .....	10 to 55 oC ambient temperature, up to 100% humidity, 2000m altitude
Noise level .....	< 70 dB (A).
Measuring instrument .....	I category (Not to be mixed with II, III, IV category).
Approvals .....	EN 61010-1 Electric safety, EN 55014-1 EMC-CE

## 4 Main components location

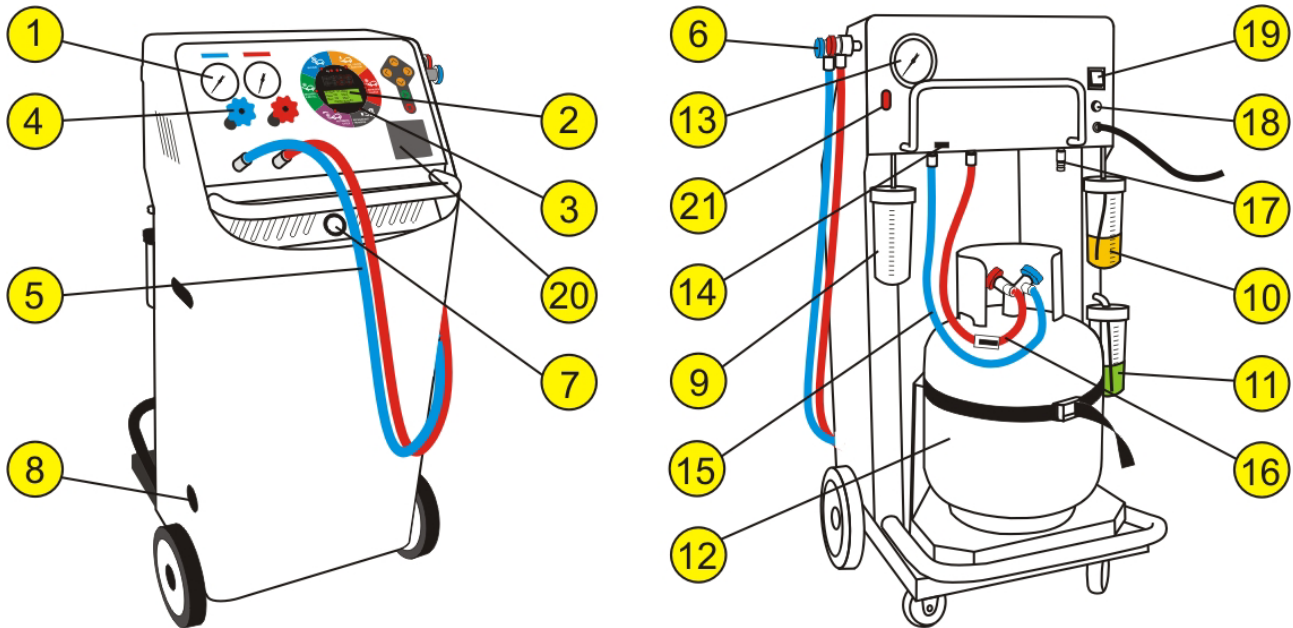

1. **Analogue gauges** - Two large analogue gauges display suction and discharge pressures. The gauges are mounted on the front panel for easy viewing by the operator. Pressures are displayed in Bar & PSI and temperatures in degrees Celsius.
2. **LED & LCD Displays** - LED numerical display and LCD display below inform the operator on weight of refrigerant and oil currently in the unit vessels, remaining vacuum time, the amount of refrigerant and oil being recovered or charged, data base of vehicles and unit set up...
3. **LED group and membrane switches (keys)**. Six LED indicates the mode and status of the unit. These are used in conjunction with 6 membrane switches (keys) to select the unit functions. Further, once the mode is in operation the pattern in which the Led's flash, indicate the activity of the system. These can be viewed from several metres away.
4. **Hand Valves** - The console hand manifold valves allows the operator to control the flow of the refrigerant (if desired).
5. **Discharge & Suction Service Hoses** - A pair of 3m hoses are connected to the console, which allows the operator to connect the system to the vehicle air-conditioning system service ports for testing system pressures, recovering and recharging refrigerant, oil and/or UV dye.
6. **Service Hose Quick Couplers** - Service hose quick couplers allows the operator to connect the unit to the vehicle air-conditioning system service ports, without exhausting the refrigerant in to the environment.
7. **Moisture Indicator** - The moisture indicator is conveniently mounted below the console for added protection to indicate the condition of refrigerant and filter change intervals. The following colours correspond to the following moisture content: Green or Blue Dry, Yellow or Pink Wet.
8. **Vacuum Pump Oil Level** - Oil level must be checked when the pump is running, the oil level should be even with the line on the vacuum pump sight glass. Under filling with oil will result in poor vacuum performance. Overfilling can result in oil blowing out from the vacuum pump exhaust.
9. **Recovered Oil Drain Reservoir** - A polycarbonate vessel of 250ml is mounted on the right rear of the unit to electronically gauge the amount of oil recovered from the air-conditioning system, if any.



10. **Oil Storage Reservoir** - A polycarbonate vessel of 250ml is mounted on the left rear of the unit to electronically inject the recovered amount of oil back in to air conditioning system, or to select the desired amount of oil to be injected.
11. **UV DYE Storage Reservoir** - A polycarbonate vessel of 250ml is mounted on the lower left rear of the unit (below the Oil Reservoir) to electronically inject UV Dye in to air- conditioning system.
12. **Refrigerant Cylinder** - 27kg capacity cylinder is used to store the recovered/recycled refrigerant. The cylinder is secured by a strap to the platform.
13. **Cylinder Non-Condensable Indicator** - A large pressure gauge is mounted on the back upper side of the unit to indicate to the technician of any non-condensable (air) built up in the storage cylinder.
14. **PC Communication Port**
15. **Cylinder Vapour Hose**
16. **Cylinder Liquid Hose with Ball Valve**
17. **Brass Adapter**
18. **Power Lead with Fuse - 10A**
19. **Power Switch**
20. **Printer**
21. **Cylinder Air Purge Ball Valve**

## 5 Preparing the Machine for the First Use

Perform the following steps to prepare the unit before the first use.

1. Remove the shrink wrap and Styrofoam insert behind the cylinder (12).

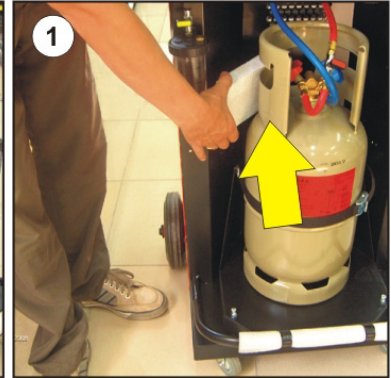
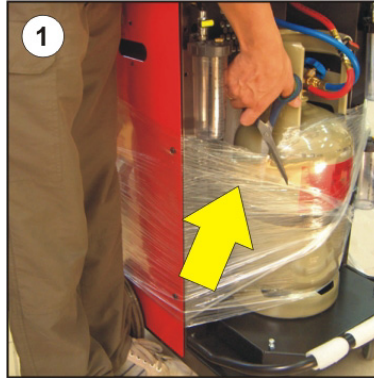

2. Check to ensure that all of the accessory components are with the unit:

- Cylinder (12)
- Adapter (17)
- Cylinder vapour hose (15)
- Cylinder liquid hose with ball valve (16)
- Service hoses with quick couplers (5)
- User's manual
- Cylinder strap

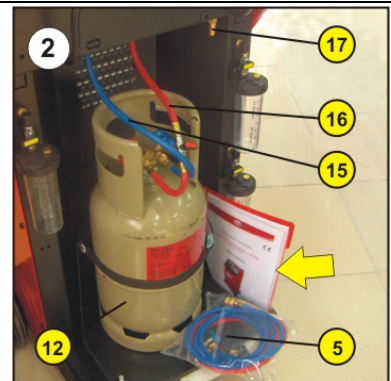

3. Check that the cylinder (12) is already placed on the platform and properly secured with the strap provided. Unscrew two securing M6 bolts placed on each side of the platform base app. 3-4 mm and LOCK the locking nut, making sure that there is 3mm clearance between the end of the safety bolt and the base of the machine.

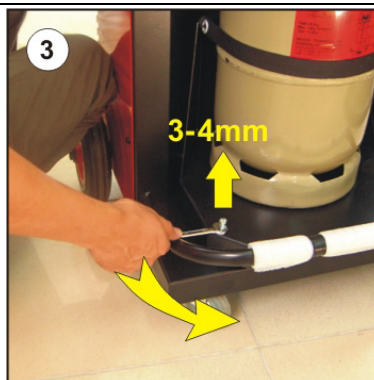



4. Check the vacuum pump oil level (8). The oil level should be even with the line on the vacuum pump sight glass when the pump is not running.

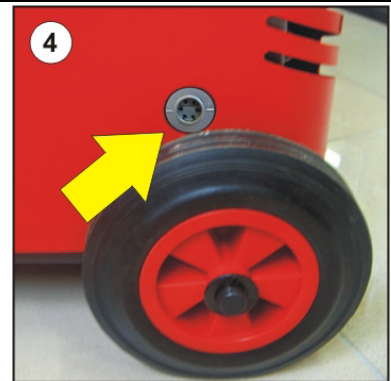

5. Power up (19) the unit. The unit will perform a lamp test, whereby all LED displays are illuminated. This will enable the operator to determine if any displays have failed. After the sequence has been completed, the displays will indicate FILT, REMAINING WORKING HOURS 99Hr. This is the number of hours left before equipment servicing is required.

In next sequence the unit is on "Stand by" and the displays are showing the amount of refrigerant in the cylinder (12), the quantity of oil in recovered oil vessel (9) and the quantity of new oil in the vessel (10).

If the cylinder is delivered empty, display should indicate approximately 0.00kg of refrigerant in the cylinder, (cylinder empty). If not, please perform TARE function (0.00kg calibration).



6. Mode Selection. To select a mode of operation, press either the "UP" or "DOWN" arrow keys until the LED indicator is beside the desired function. Press 'START' key which will cause the unit to enter the selected mode. Any mode that has been selected can be exited by pressing the 'STOP' key. Note, that if a valid key was depressed, the unit will beep. If an inappropriate selection has been made, i.e. attempting to select a mode whilst another mode is in operation, the unit will ignore the pressed key and will not beep.



7. Refrigerant cylinder (12) fitted on a platform is evacuated during the production process.

**Note, please check if refrigerant cylinder (12) is evacuated** (during transport, vacuum could be lost). If the vacuum is lost, please perform the following steps to evacuate refrigerant cylinder (12) before filling it with refrigerant:

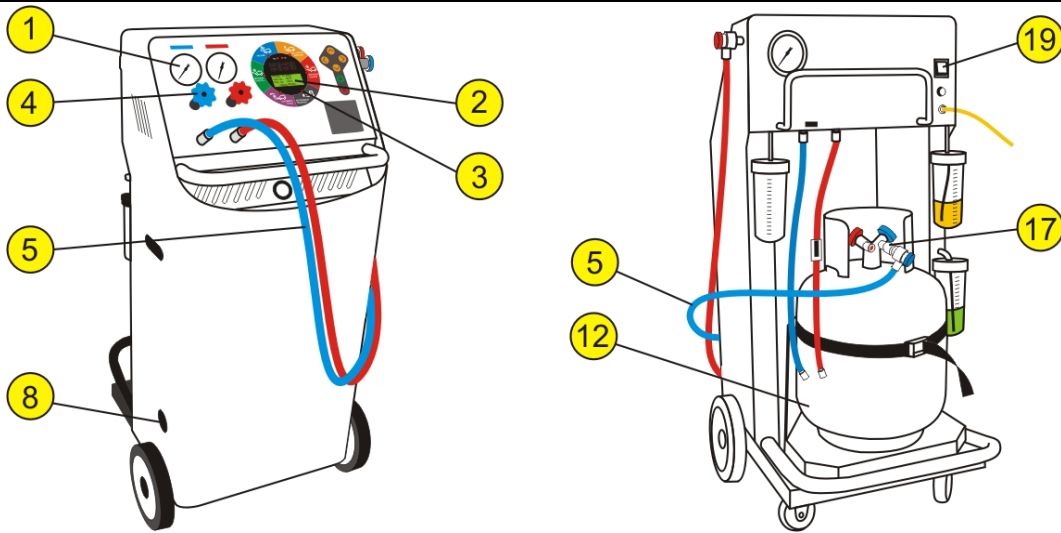

- Connect blue service hose (5) to cylinder (12) by using adaptor (17).
- Open cylinder (12) valve, service hose (5) quick coupling and manifold hand wheel (4) on the unit panel.
- Press the "UP" key twice to select evacuation function. Press "START" and with the "UP" and "DOWN" key select 30 minutes. Press "START" key again and the unit will start the evacuation process.
- After 30 min. the unit will automatically stop. **Close the cylinder valve**, disconnect the service hose (5) and adaptor (17) from cylinder, place adaptor on the storage port and connect liquid hose (16) to the cylinder liquid port and vapour hose (15) to the cylinder vapour port.

**⚠ NOTE:** LIQUID AND VAPOR HOSES MUST BE CONNECTED TO VAPOR AND LIQUID PORTS ON THE STORAGE CYLINDERS. INCORRECT CONNECTION WILL CAUSE CHARGING TO BE VERY SLOW.

8. Open both cylinder valves and open liquid hose (16) ball valve.

The WOW! Coolius 2700 is now ready for use.

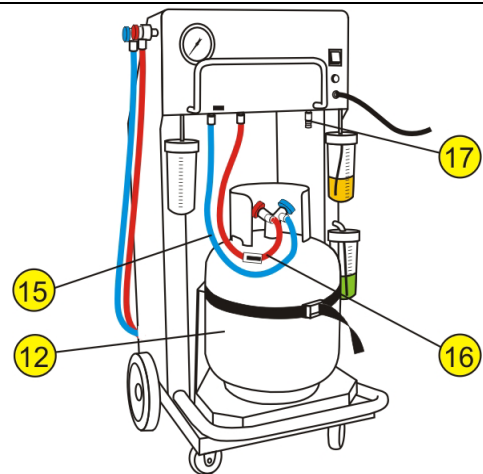

## 6 Printer

The printer is equipped with two keys and green led:

>> Paper feed

II on line / off line

The green led shows the state of the printer:

**Led constantly ON** - Printer in line

**Led blinking** - Printer not in line or no paper

**Led off** - Press II. If the problem persists, contact authorized distributor or manufacturer.

**Printer roll specifications,**

Paper width: 57-58mm

Max paper thickness: 80  $\mu$

**Printing report:**

After completion of every operation the unit will print a report as follows --->

REFRIGERANT RECOVERY

g. 550

VACUUM

min. 20

RECOVERED OIL

ml 14

OIL INJECTION

ml 14

UV DYE INJECTION

yes no

REFRIGERANT CHARGE

g. 650

Date: 16 Jul 07

Time: 15:40

Client: \_\_\_\_\_

TALARICO A/C SERVICE CENTER

55 NORTHGATE DRIVE,

THOMASTOWN, MELBORNE

TEL: + 61 3 9464 5688

FAX: + 61 3 94 64 5788

www.talarico.com

How to open printer cover



How to load paper roll



How to close the cover



## 7 Refrigerant Cylinder Filling Procedure (Refrigerant Transfer)

The cylinder (12) may be filled with refrigerant by following procedures.

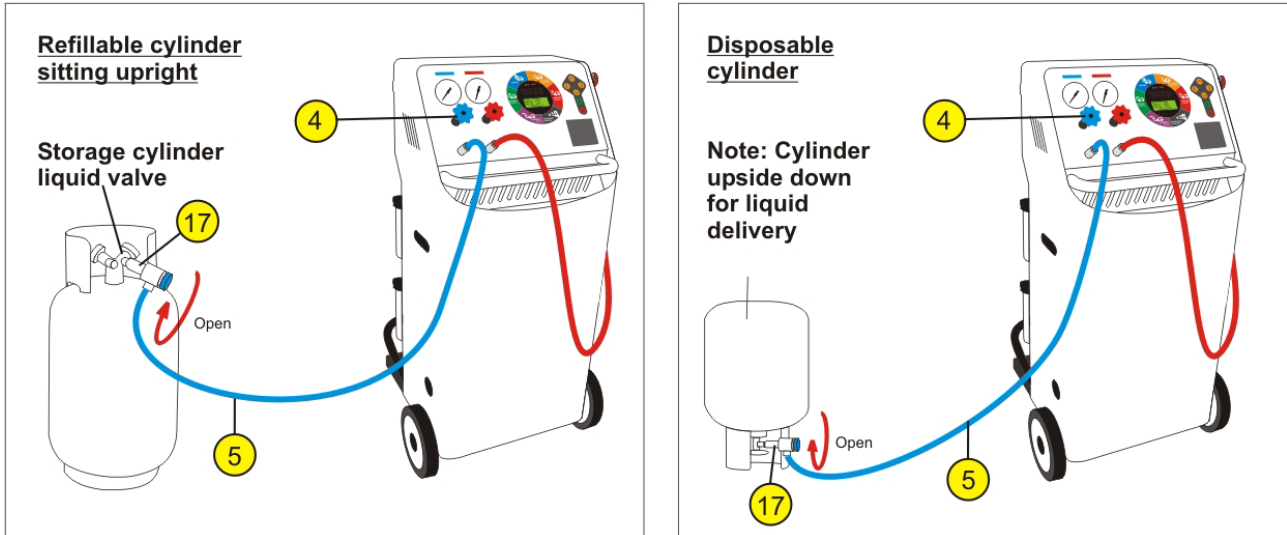

### 9. Using refillable cylinder procedure

Have the cylinder sitting upright, connect the suction (blue) service hose (5) to storage cylinder liquid valve by using the refrigerant cylinder adapter (17), open liquid valve on storage cylinder, open service hose quick coupling (5) and console blue hand valve (4) >>>

### 10. Using disposable cylinder procedure

Connect the suction (blue) service hose (5) to a storage cylinder valve by using the refrigerant cylinder adapter (17). Turn cylinder upside down for liquid delivery, open the valve on the storage cylinder, open service hose quick coupling (5) and console blue hand valve (4) >>>

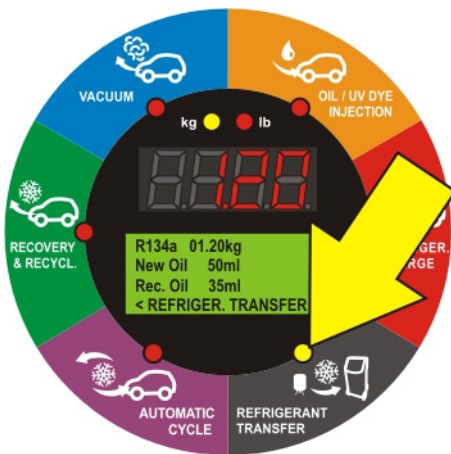

>>>

Press "DOWN" key twice to select the REFRIGERANT TRANSFER function and press "START". With "UP" or "DOWN" keys select between TOTAL TRANSFER (all) or PARTIAL TRANSFER (set the amount of refrigerant to be transferred). Press "START" key and unit will automatically transfer the selected amount of refrigerant from storage cylinder to the unit cylinder (12).

When the selected amount of refrigerant is transferred, close the storage cylinder valve and allow the unit to recover the refrigerant from the service hose (5). Once the function is completed the unit will display symbol "DONE" and the amount of refrigerant transferred will be displayed in kg or lb on main display (2).

**IMPORTANT:-** Always keep a minimum of 2 kg in the cylinder (12).

**IMPORTANT:-** Do not allow the cylinder (12) to be filled above 80% capacity.

**IMPORTANT:-** Never transport an overfilled cylinder. Refrigerant expands when heated and may cause the pressure relief valve to open and exhaust refrigerant in to the atmosphere or the cylinder may rupture

## 8 Connecting to the A/C system

Use the service hose (5) quick-connect couplers to connect the hoses to the A/C system service ports, bearing in mind that **BLUE** must be connected to the low-pressure (**suction**) side and **RED** to high pressure (**discharge**) side.

If the system is equipped with a single service port, connect only the relative hose.

**NOTE:** Before connecting the quick couplers, clean the a/c ports of any foreign material

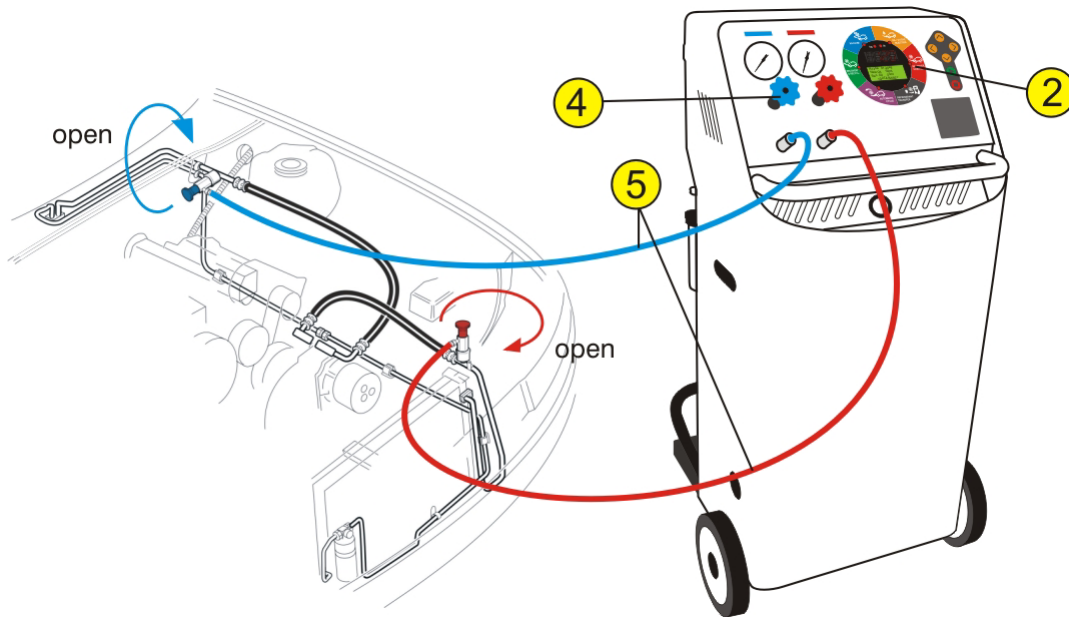

Winding the quick coupler hand wheel clockwise, will allow the refrigerant to flow through the hoses. Turning hand wheel in opposite direction, the flow will be closed. If there is any refrigerant in the air-conditioning system, the pressure gauges will indicate a pressure rise.

**IMPORTANT:** Console manifold hand valves (4) need to stay closed, NOT to allow refrigerant to enter into the unit until the required function has been selected.

The unit gauges (suction & discharge) are important and useful instruments.

The operator should have basic understanding between gauge reading and air-conditioning system operation, in order to correctly diagnose any possible system malfunction.

## 9 Manual function selection procedure

With this procedure, all functions (Refrigerant Recovery & Recycling, Recovered Oil Drain, A/C System Evacuation, New Oil and/or UV Dye Injection and Refrigerant Charge) can be performed individually (step by step).

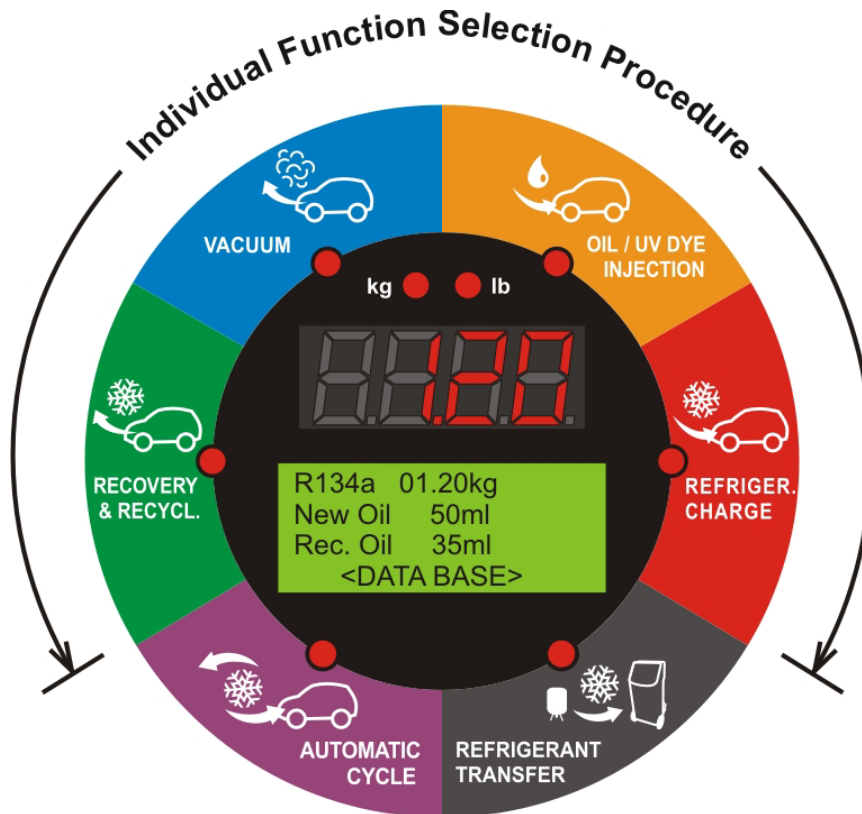

The values for the quantity of refrigerant recovered, quantity of the oil recovered, vacuum time, quantity of oil injected and quantity of refrigerant charged into the a/c system are automatically printed at the end of each single operation.

### 9.1 Recovery & Recycling Mode

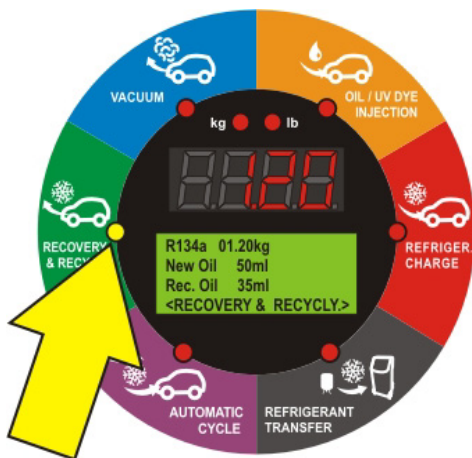

The purpose of the Recovery & Recycling mode is to recover refrigerant from the air conditioning system, which will condense, purify and store the liquid refrigerant in the storage cylinder ready for re-use.

To initiate the Recovery mode, press the 'UP' key once, followed by 'START' on the console. Display will show:



1. **TOTAL RECOVERY** to recover the whole amount of the refrigerant from the A/C system or storage cylinder.
2. **PARTIAL RECOVERY** to select desired quantity of refrigerant to be recovered from the a/c system or storage cylinder. After the quantity selection is made, press "START" key.

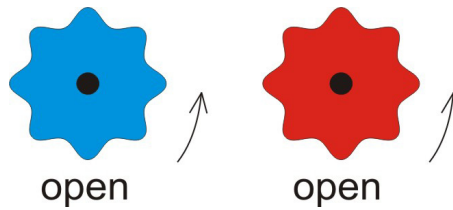

**NOTE:** Open the hand manifold valves (4) on the console to allow the flow of the refrigerant from the a/c system before making the above selection (valves on the unit storage cylinder (12) and ball valve on the cylinder liquid hose (16) must be open also).

During the recovery process, the 'Recovery' mode LED indicator will blink and the display (2) will indicate the amount of refrigerant being recovered.

In normal operation the above condition will be maintained until a vacuum of -0.4 bar is reached at either the discharge or suction ports. When this occurs, the machine will beep once, and the unit will enter in Recovery "PAUSE" mode. In this mode, the unit will shut down the Recovery function and pause for 180 seconds, which during this time the recovery mode enunciator will be ON constantly. The display (2) will indicate "PAUSE". During this function, the unit is monitoring whether the air-conditioning system pressure is increasing, due to any refrigerant that may be left in the accumulator or dryer. If the pressure increases above zero, the machine will re-start the recovery function automatically and recover the remaining refrigerant.

If at the end of Recovery process a sufficient vacuum of -0.4 Bar has been maintained, the unit will stop, and the display (2) will indicate 'DONE' and the amount of refrigerant recovered will be displayed in kg (or lb) depending on the operator's selection.

Press 'STOP' on the console, the unit will display "busy" for 5 seconds.

The value of the quantity of refrigerant recovered will be automatically printed.

## Recovered Oil Drain

After completing the recovery function, the unit will automatically drain the recovered oil (if any) into recovered oil vessel (9) to electronically calculate amount of oil that has been recovered. The value of the recovered oil will be automatically printed.

## Conditions that will halt the recovery mode

The above sequence assumes that neither the stop button was pressed, or that no undesirable condition occurred. The following conditions will cause the unit to halt the recovery function.

1. **Refrigerant cylinder (12) full.** To protect the storage cylinder from being overfilled, the unit will not allow the operator to recover refrigerant once it has reached 80% of its capacity. "CYL FULL" will be displayed.
2. **Air conditioning system empty.** If the A/C system pressure is not above atmospheric pressure, the recovery function will not be activated. "NO REF" will be displayed.
3. **High Pressure.** If the operating pressure of the unit exceeds 25 bar (340 PSI), the unit will stop and display 'H-PRES'. The following can cause the above:
  - o Cylinder (12) valves not open.

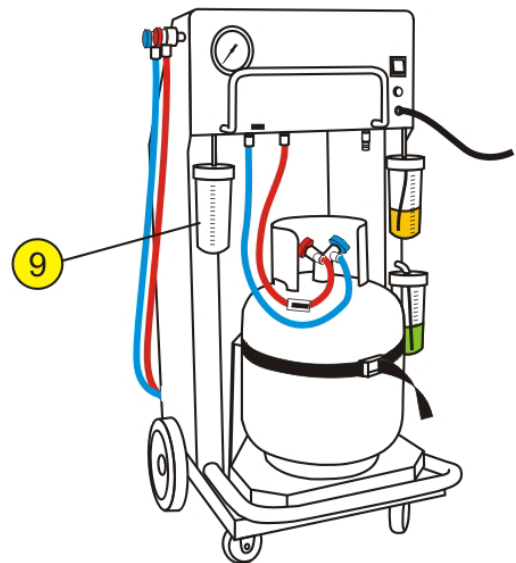

- Restricted cylinder hose (16). Check the ball valve.
- Excessive high ambient temperatures.
- Excessive air in refrigerant cylinder (12).
- Faulty pressure control

In all the above circumstances, press the 'STOP' key to return to the machines initial mode.

If the above conditions are ok and the 'H-PRES' display keeps on appearing, contact your local distributor or manufacturer for further advice.

## 9.2 Evacuation Mode

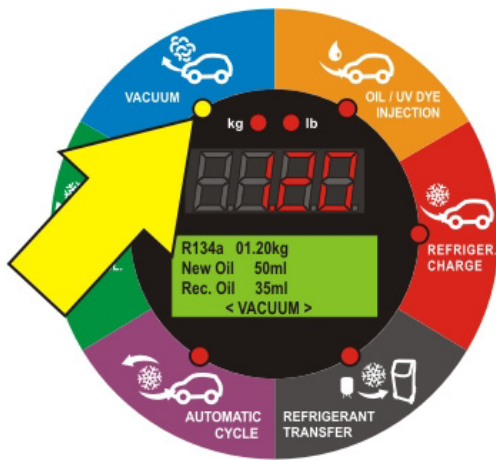

In the evacuation mode the air and moisture in the air conditioning system is removed and exhausted to the atmosphere. The evacuation mode runs for a predetermined time selected by the operator.

To initiate evacuation mode, press the 'UP' key twice, followed by the 'START' key. Select the desired evacuation duration by pressing the 'UP' key to increase or 'DOWN' key to decrease time duration. Once the desired time has been selected, press the 'START' key and the function will commence.

The evacuation time can be set from one minute to eight hours.

**NOTE:** During evacuation mode the manifold hand valves (4) on the console must be open.

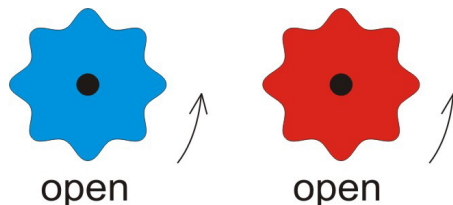

At any time the evacuation time can be paused or cancelled by pressing the stop button once to pause, or twice to cancel the function.

The unit has a unique function that if the evacuation function is selected and there is residual refrigerant in the air conditioning system, greater than 0.5 Bar (10 PSI), the unit will detect this condition, whereby it will beep six times to warn the operator. After this warning the unit will automatically recover the residual refrigerant once it has recovered the entire refrigerant it will start the selected evacuation function automatically.

**Leak testing A/C system:** After the evacuation process is completed, close both hand valves on console (4). By closing the valves the unit is "isolated" from the A/C system to allow for monitoring of any possible vacuum leak that may exist in the air- conditioning system. This is achieved by monitoring the suction gauge.

After completion of evacuation function, the unit will automatically print the report.



### 9.3 Öl- und UV-Farbstoffeinfüllung

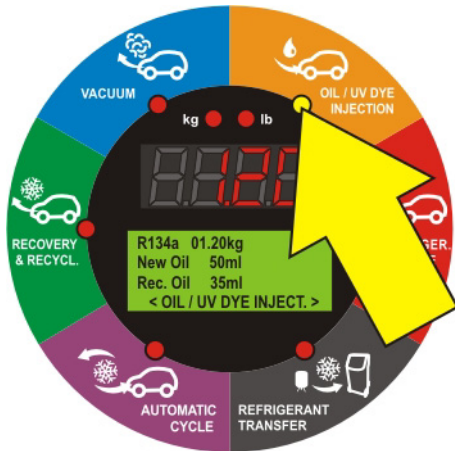

The purpose of this function is to batch a user-defined quantity of refrigerant oil or UV dye from the oil reservoir (10) to the vehicle air-conditioning system.

**Important:** The unit requires that the air conditioning system has previously been evacuated to a maximum vacuum before this function can be carried out.

Make sure you have sufficient refrigerant oil and UV dye in the vessels (10 & 11) and select the Oil/UV Dye Injection mode by pressing the 'UP' or 'DOWN' keys, followed by the 'START' key. Now the display will show the following:

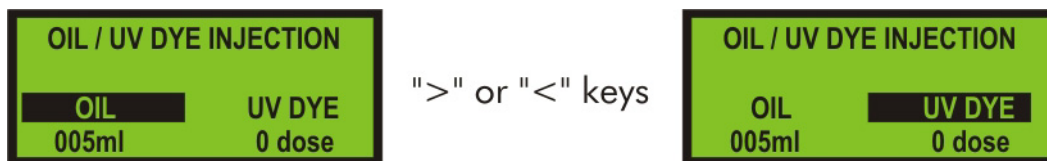

Select the desired amount of refrigerant oil ('UP' key to increase or 'DOWN' key to decrease the volume). With ">" key go to UV DYE and again with "UP & DOWN" keys select the desired number of UV Dye doses (1 dose ~7ml).

Once the desired amount has been selected press the 'START' key and open only the discharge (Red) hand manifold valves (4) on the console.

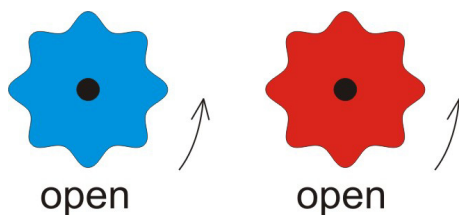

*(On A/C systems without discharge port, ref. oil and UV dye can be carefully injected through suction (blue) hand valve .in this case open only suction (blue) hand valve (4) on the console)*

After completion of oil injection, the unit will automatically print the report of the oil injected into the A/C system.

#### Conditions that will prevent oil injection

- The unit will not inject oil if the following conditions exist:
  - Insufficient vacuum.
- Hand manifold valves (4) not opened on console.
- Schrader valve on A/C system service port not depressed.
- No oil in the reservoir (10).

## 9.4. Refrigerant Charge Mode

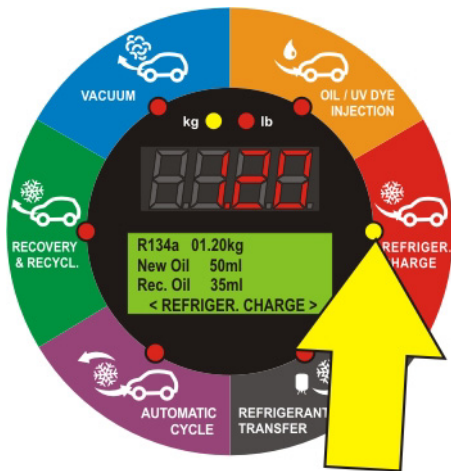

The purpose of the refrigerant charge mode is to batch a user-defined weight amount of refrigerant into the air-conditioning system.

**IMPORTANT:** It is recommended that the A/C system is always properly evacuated and leak tested, before refrigerant is charged in to the A/C system.

To initiate charging mode, press the 'UP' key four times, followed by the 'START' key. The display will show the following

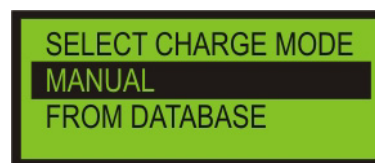

Select the desired charging mode **MANUAL** or **FROM DATABASE** and set the amount of refrigerant to be charged into the a/c system (with 'UP' key to increase or 'DOWN' key to decrease in manual mode, or by selecting the vehicle make and model from database). The smallest increment of refrigerant charge weight is 0.01 kg (if the units of weight are to lb the smallest increment of refrigerant charge weight is 0.02lb).

Holding the 'UP' or 'DOWN' keys for longer than two second will cause the increments of weight change to increase or decrease rapidly.

Once the refrigerant charge weight has been set, press the 'START' key and open appropriate hand manifold valve depending on whether you are charging with the engine running or engine stationary (if the A/C system is **OFF** or **ON**)

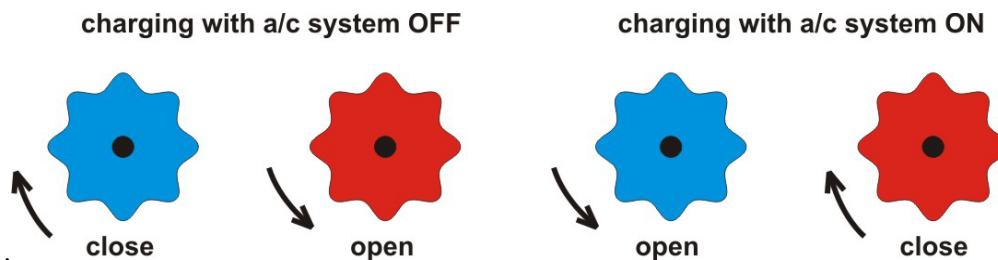

Once the present refrigerant weight has been charged, the charge function will automatically stop and the display will indicate 'DONE'. The operator can return the machine to its initial state by pressing 'STOP' key on the console.

After completion of refrigerant charge, the unit will automatically print the report of the amount of refrigerant charged into the A/C system.

### Conditions that will prevent refrigerant charging

- If there is little or no refrigerant in cylinder (12). The operator will not be able to select the desired amount of refrigerant required.
- If the cylinder (12) valve is closed.
- If the hand manifold valve (4) is closed.
- If the A/C system service port Schrader valve is not depressed

## 10 Automatic Cycle Procedure

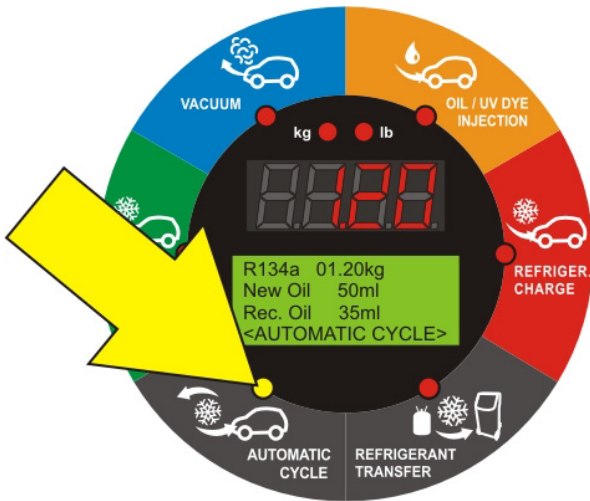

In the Automatic cycle mode, all the operations will be performed one after the other.

(Refrigerant Recovering and Recycling, Recovered Oil Drain, System Evacuation, New Oil Injection and Refrigerant Charging) are performed automatically, in one cycle.

Quantity of the refrigerant recovered, recovered oil, vacuum time, new oil injected and refrigerant charged into the A/C system are printed at the end of each single operation.

To initiate the Automatic cycle mode, press the 'DOWN' key once, followed by 'START' on the console.

To initiate the Automatic cycle mode, press the 'DOWN' key once, followed by 'START' on the console. The display will show the following:

**< AUTOMATIC CYCLE >  
RECOVERY & RECYCL.**

Press "START" button to confirm the recovery function.

**< AUTOMATIC CYCLE >  
SET VACUUM TIME  
00:01:00**

By pressing the 'UP' key to increase or 'DOWN' key to decrease select the desired Evacuation Time Duration. Once the desired time has been selected press the 'START' key

**< AUTOMATIC CYCLE >  
OIL/UV DYE INJECTION  
AUTOMATIC  
MANUAL**

Oil/UV Dye injection. The operator can choose between:

- **AUTOMATIC** oil injection. The unit determines the quantity of oil extracted during the recovery process and will inject the same quantity back in the a/c system. The quantity of UV dye can be selected also.
- **MANUAL**, with 'UP' key (to increase) or "DOWN" key (to decrease) select the amount of refrigerant oil and/or UV dye to be injected into the a/c system. ">" and "<" keys to change oil or UV Dye selections. Once the desired amount has been selected, press the 'START' key.



< AUTOMATIC CYCLE >  
SELECT CHARGE MODE  
MANUAL  
FROM DATABASE



< AUTOMATIC CYCLE >  
SELECT CHARGE MODE  
SET REF. CHARGE  
00.10kg

< AUTOMATIC CYCLE >  
SELECT CHARGE MODE  
MANUAL  
FROM DATABASE



< SELECT VEHICLE >  
AUTOMOBILE  
TRUCK



SELECT MANUFACTURER  
ALFAROMEIO  
ASTON MARTIN  
AUDI

Select the desired charging mode, MANUAL or FROM DATABASE and set the amount of refrigerant to be charged into the a/c system (with 'UP' key to increase or 'DOWN' key to decrease in manual mode or by selecting the vehicle from database). The smallest increment of refrigerant charge weight is 0.01 kg (if the units of weight are to lb the smallest increment of refrigerant charge weight is 0.02lb). Holding the 'UP' or 'DOWN' keys for longer than two second will cause the increments of weight change to increase or decrease rapidly..

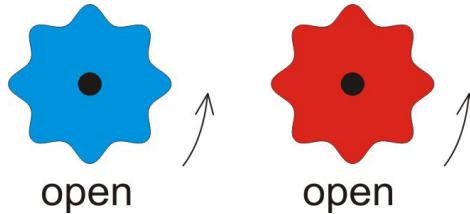

Once the refrigerant charge weight has been set, open both hand manifold valves and press the 'START' key.  
**Note: A/C system must be OFF.**

The unit will perform all tasks in one automatic cycle and will print reports at the end of each single operation.



## Conditions that will prevent automatic cycle procedure

1. If there is little or no refrigerant in cylinder (12). Display shows "ADD REF". The operator must add refrigerant into unit cylinder (12).
2. If the recovered oil vessel (9) is full, and display will show "OIL FULL". The operator must empty the recovered oil vessel. Dispose of used oil properly.

**NOTE:** If the recovered oil vessel becomes full during the oil drain, the process will be stopped. Display will show "OIL FULL". Operator must empty the vessel and press "STOP". The automatic cycle will continue..

3. If new oil vessel (10) is empty display will show "ADD OIL". The operator must fill the oil vessel.

**NOTE:** During the process of oil injection, if there is insufficient oil in the new oil vessel (10), the display will show "ADD OIL". The operator must add the oil in the vessel and press "STOP". The automatic cycle will continue.

4. If the refrigerant cylinder (12) is full. To protect the storage cylinder from being overfilled, the unit will not allow the operator to recover refrigerant once it has reached 80% of its capacity.
5. If the hand manifold valve (4) console are closed
6. If the A/C system service port Schrader valve is not depressed.
7. High Pressure. If the operating pressure of the unit exceeds 25 bar (340 psi), the unit will stop and display 'H- PRES'. The following can cause the above:
  - o Cylinder (12) valves not open.
  - o Restricted cylinder hose (16). Check the ball valves.
  - o Excessive high ambient temperatures.
  - o Excessive air in refrigerant cylinder.
  - o Faulty pressure control
  - o Recovery pump thermo control faulty.

In all the above circumstances, press the 'STOP' key to return to the machines initial mode.

If all the above conditions are OK, contact your local distributor of manufacturer for further advice.

## 11 Cylinder Air Purge

Once a week check if there is non-condensable (air) build up in the refrigerant cylinder.

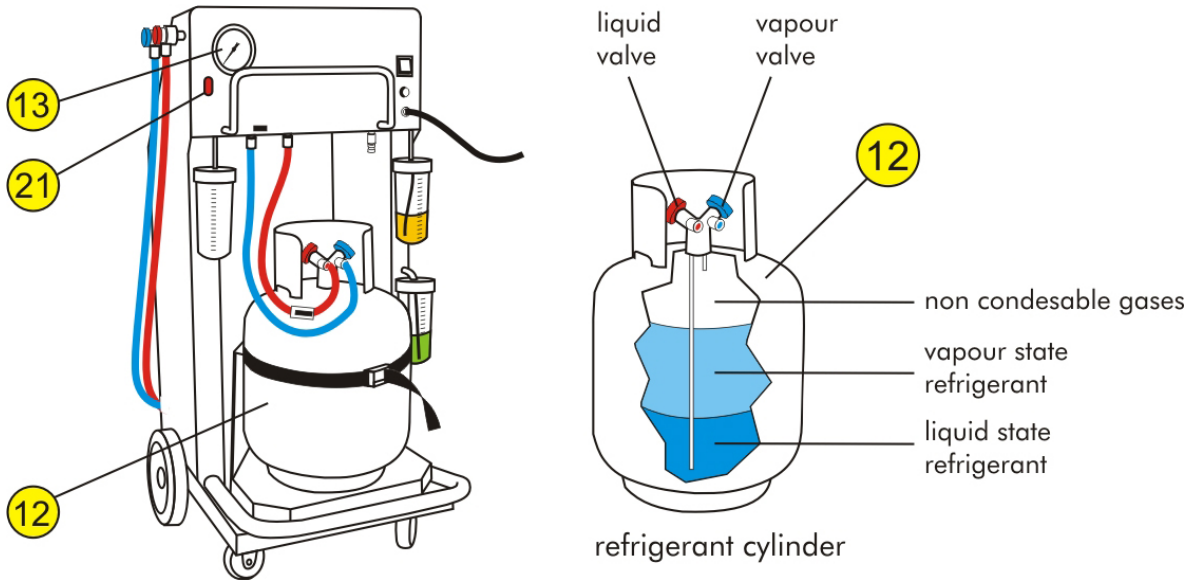

First, measure the ambient temperature. Then read the cylinder pressure on rear gauge (13) and compare it with the temperature pressure chart, affixed to the machine.

If the cylinder pressure is higher than the pressure/temperature chart, there are non-condensable gases (air) in the cylinder (12). Slightly OPEN ball valve (21) to purge the non-condensable gases (air) from the cylinder (12) and bring back the pressure to the recommended chart values.

**NOTE:** After recovery process is normal that cylinder pressure is higher than the pressure/temperature chart shows. Always read the cylinder pressure gauge (13) first thing in the morning before operating the machine.

**Example:** Ambient temp. 20 °C, the cylinder pressure should be 4.7 bar.

Ambient temperature (Co)	Air purge gauge readings	
	bar	PSI
8	2.9	42
12	3.4	49
18	4.3	63
20	4.7	68
22	5.1	73
24	5.4	79
26	5.8	84
28	6.2	90
30	6.7	96
34	7.6	110
38	8.6	124
42	9.7	14.1
46	10.9	157
50	12.1	175



## **12 Contact**

### **Supplier address**

WoW! Würth Online World GmbH

Schliffenstrasse Falkhof

D-74653 Künzelsau

Fax: +49 (0) 7940/15-3299

info@wow-portal.com

<http://www.wow-portal.com>

